

Objective: Separate the ring with the metal string from the puzzle.

Too difficult?

Take a hint from the solution below.

**To Separate:**

1. Start from Position 1. Pull the chain up through up ring.(Step 1)
2. Continue the chain and pass it through the top. (Step 2)
3. Pull the whole lot down and pass through the lower ring. (Step 3)
4. Now the ring should come off.

**To Reattach**

Make the reversed steps of the above.

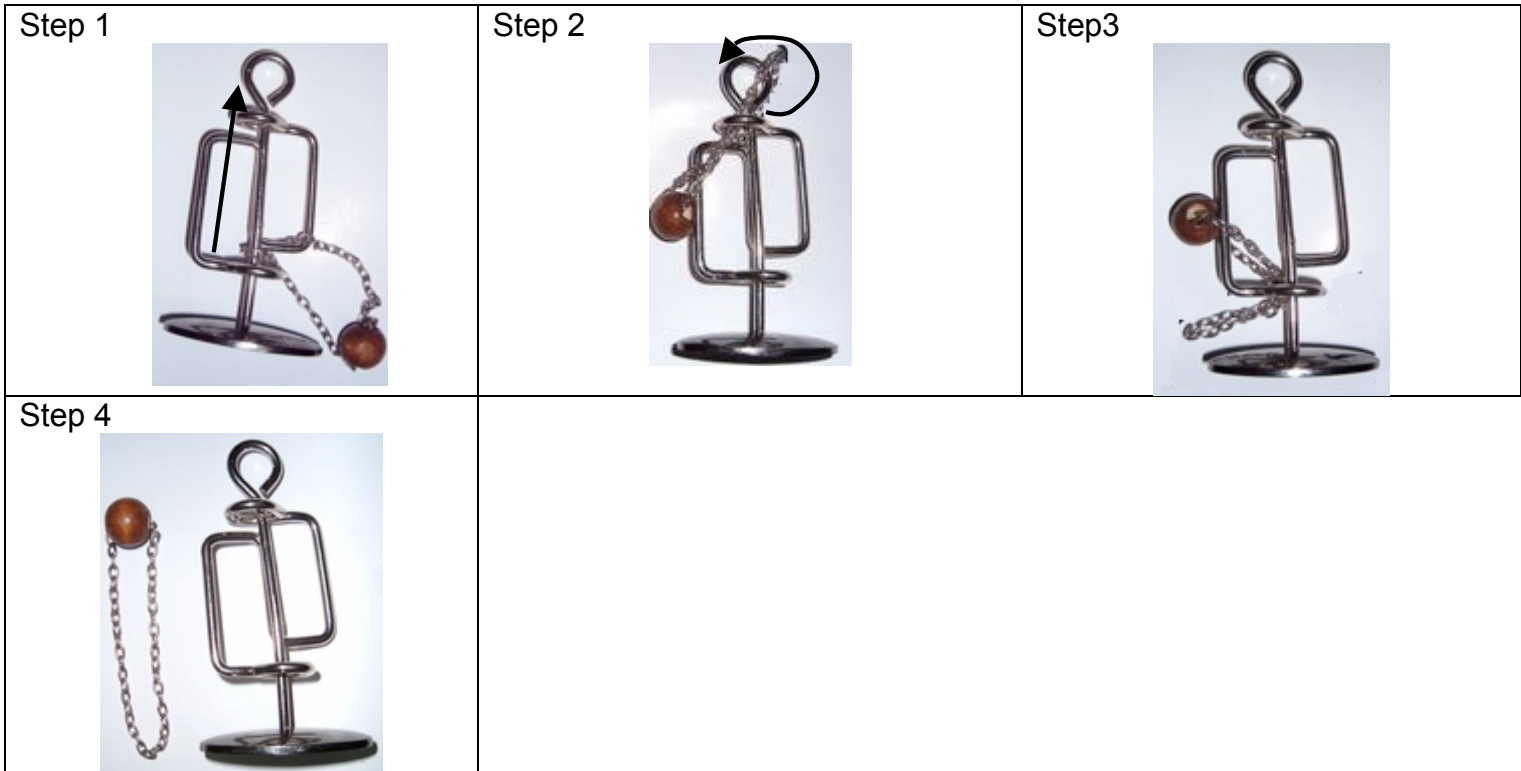

ENJOY!