

Objective: Separate the ring from the puzzle.

Too difficult?

Take a hint from the solution below.

To Separate:

1. Start from Step 1 position.
2. Pass the chain through the two doors (Step 2).
3. Pass the chain end through the ball (Step 3).
4. Pull the whole lot back to the left. Now the ring should come off (Step 4).

To Reattach

Make the reversed steps of the above.

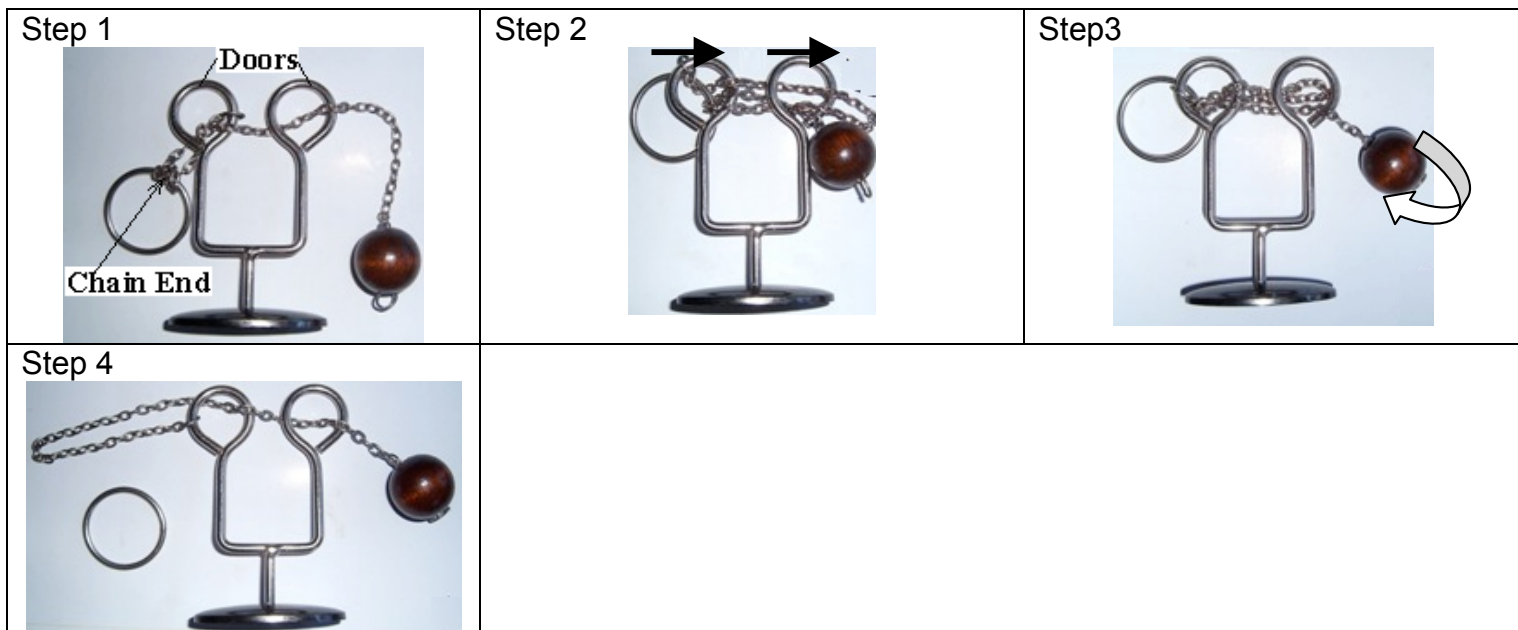

ENJOY!