

Objective: Separate the ring with the metal string from the puzzle.

Too difficult?

Take a hint from the solution below.

To Separate:

1. Start from Step 1 Position. Pass the chain through ring No. 1 as arrow points.
2. Continue the chain through ring No. 3 as arrow points, and pull the chain back. Now you should reach step 3 Position. Continue through ring 2 and 1 in arrow pointed position.
3. Now you should reach step 4 position. Pass the chain through ring 4 and 3 in arrowed position as in step 4.
4. Now you should reach step 5 position. Pass the chain through ring 4 and 3 in arrowed position as in step 4.
5. Now you should be able to release the chain.

To Reattach

Make the reversed steps of the above.

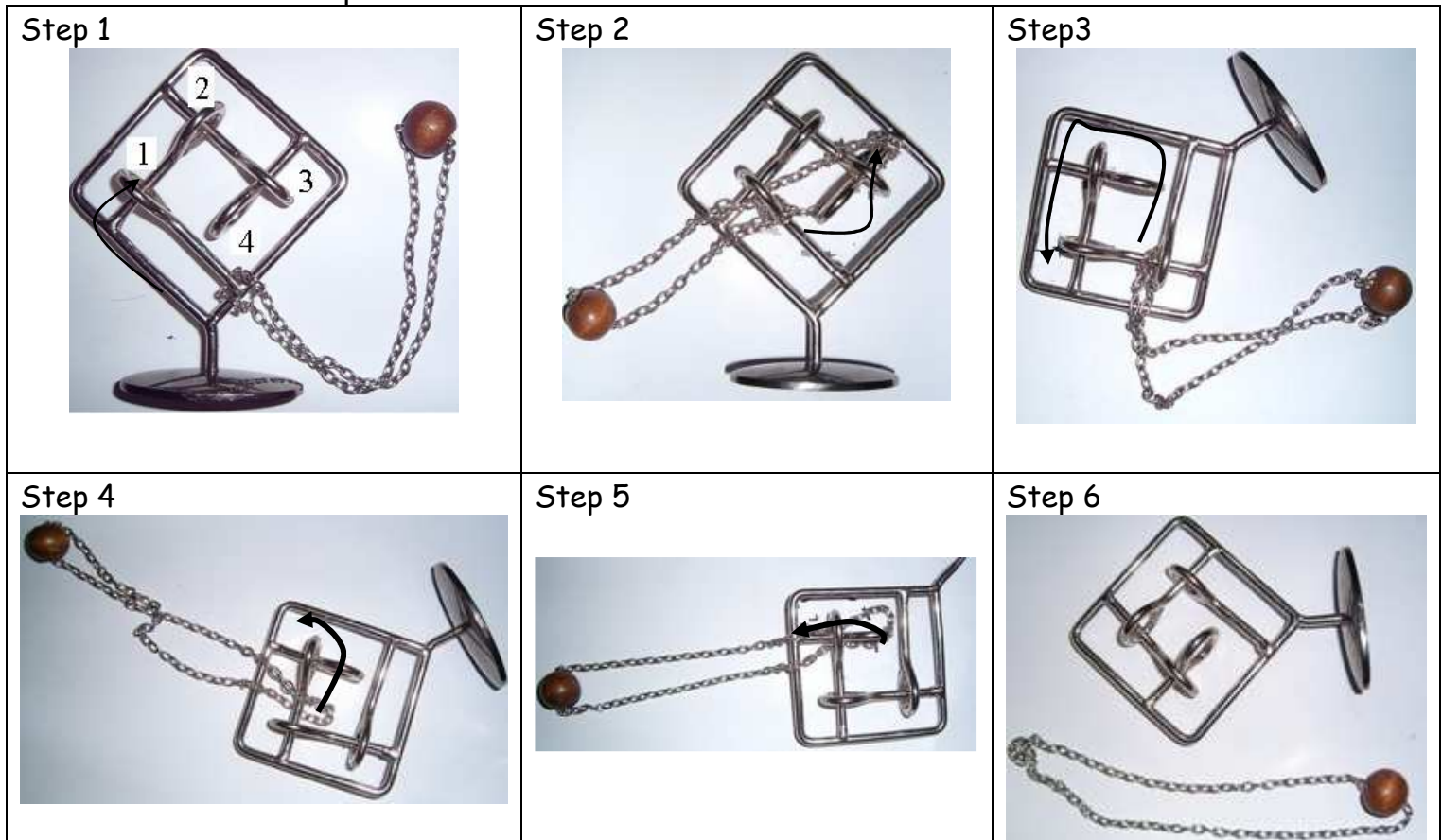

ENJOY!